

osnova stana

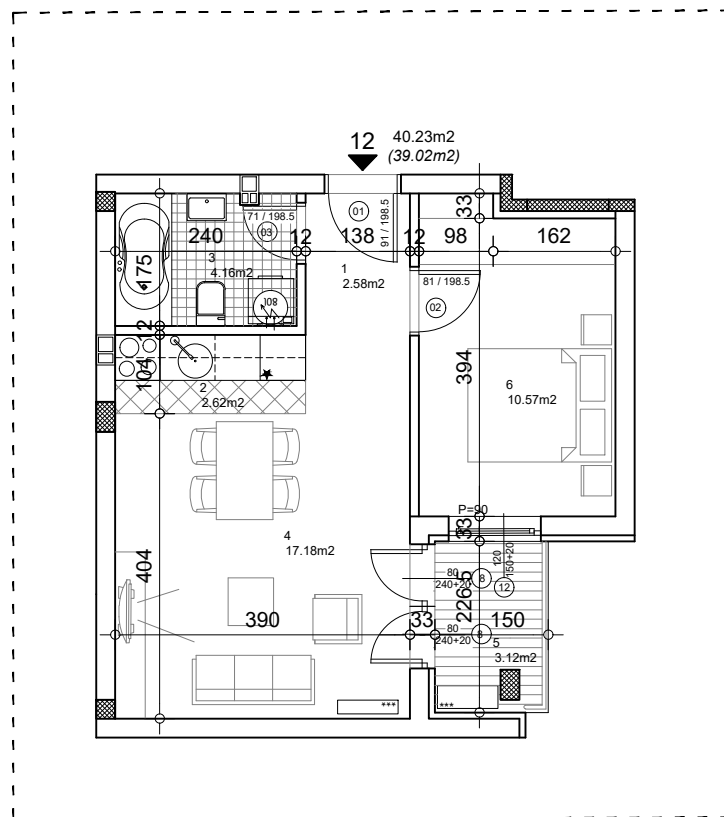

STAN 12 - dvosoban

ulaz	1	2.58	2.50	klas.parket
kuhinja	2	2.62	2.54	keramika
kupatilo	3	4.16	4.04	keramika
dn.soba sa trpez.	4	17.18	16.66	klas.parket
balkon	5	3.12	3.03	keramika
sp.soba	6	10.57	10.25	klas.parket
	ukupno	40.23	39.02	

OSNOVA 2. SPRATA



ULIČNA FASADA

